



AFFORDABLE PLOTTED HOUSING SCHEME

Under DDJAY (Deen Dayal Jan Awas Yojna)
Affordable Plotted Housing Policy 2016 of
Haryana Government





Green Circle Homes is secured gated development launched under Deen Dayal Jan Awas Yojana Affordable Plotted Housing Policy 2016 in Sector-27 of Ambala that offers you the choice of building your dream home.

Independent Plots starting from

₹16 LAKHS*

Residential Plots - 80 to 180 Sq. Yds. in Sector-27, Ambala

RERA APPROVED

HRERA No. 137 of 2019 For 9.08 Acres

**LEAP TO
THE NEXT
LEVEL OF
PLOTTING**





Actual Photograph of Site



WIDER ROADS



Actual Photograph of Site



Amenities for Better Living



24X7 Security



Children Play Area



Community Parks



9 & 24 mtr. wide Roads



LED Street Lights

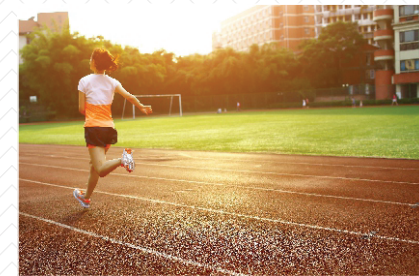

Jogging Track

Dedicated area marked for community facilities
Smart distribution of power and water supply
and much more...



Community Facilities Area 1.1866 Acres



Commercial Area 0.4739 Acres



KEY HIGHLIGHTS

1

Green Circle Homes- a 20.93 acres premium township in the arms of Ambala.

2

Nearing Possession

3

Self sufficient & fully planned township with maximum green cover.

4

Strategically located in Sector-27 near "Rajiv Gandhi Sports Complex" –a National level stadium in Sector-10, Ambala.

5

Community living –a sense of belonging, security, sharing of resources, healthy, cooperation and fun filled life.

6

Underground sewerage with separate storm water drainage system that prevents water-logging.

7

Subsidy upto 2.67* lakhs

8

Facing "45.0 M" & "24.0 M" Wide Roads, 9.0 M Wide Internal Roads.

9

24x7 Security with well trained guards, Community Centre, Clean Roads, Street Lights, Transformers, Insulated Wires.



GREEN Circle Homes Location Map

Sector-27, Ambala

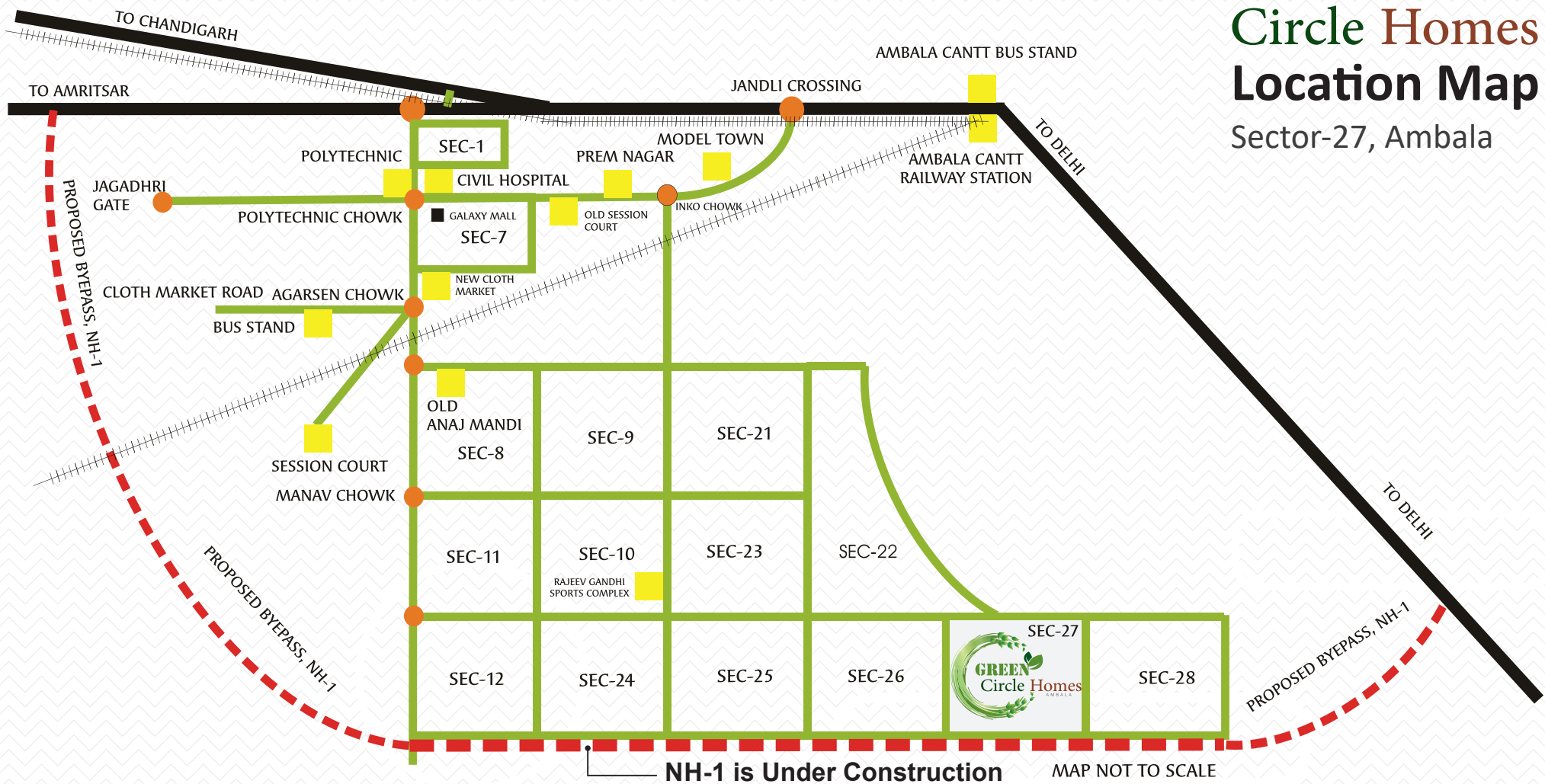



SITE LAYOUT PLAN

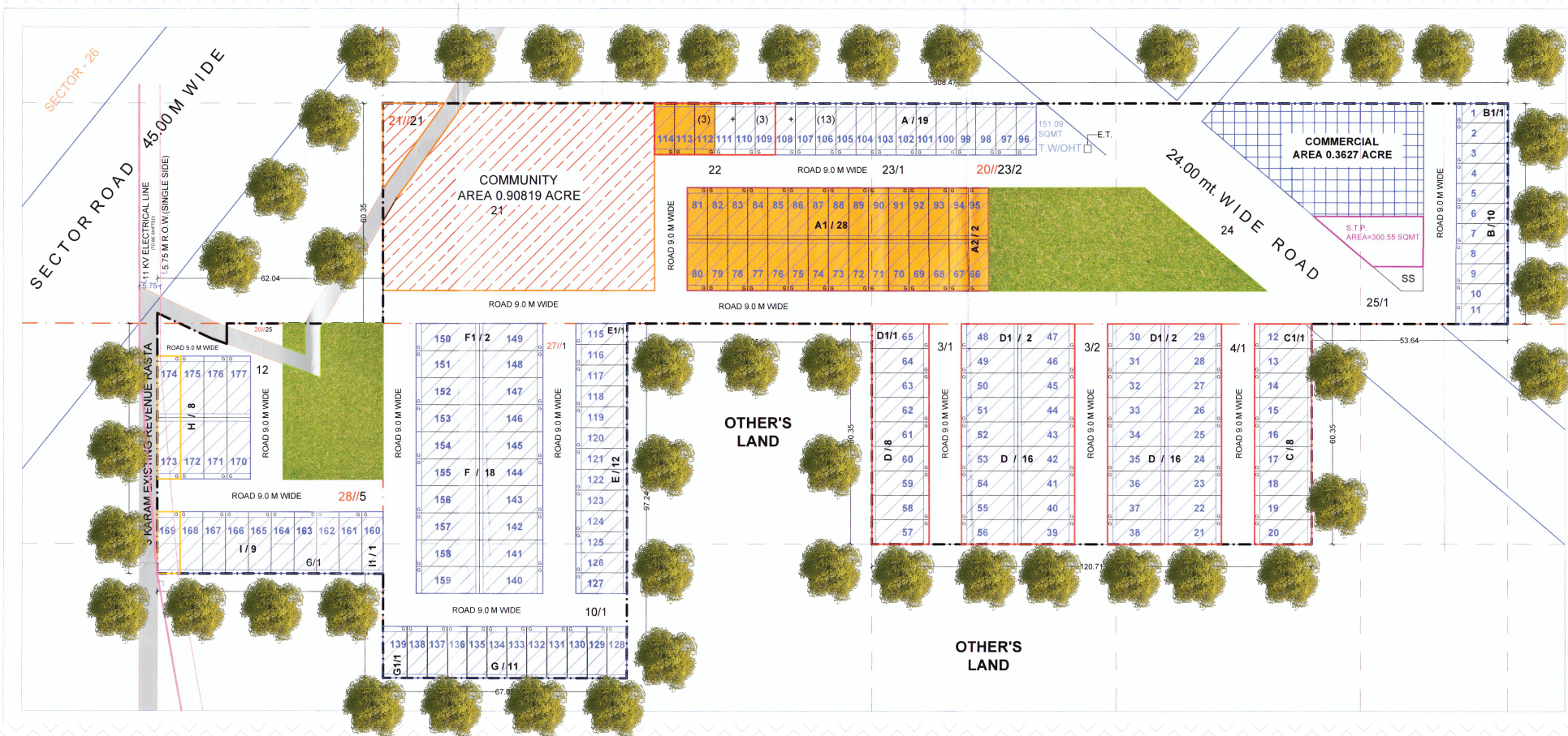

AFFORDABLE PLOTTED HOUSING SCHEME



PRADHAN MANTRI AWAS YOJANA

AVAIL BENEFITS UNDER PRADHAN MANTRI AWAS YOJANA (PMAY*) CREDIT LINK SUBSIDY SCHEME (CLSS) OWN A HOME AND SAVE UPTO ₹ 2.67 LACS AND INTEREST SUBSIDY UPTO 6.5 % PER ANNUM**

DISCLAIMER:

"THIS PICTURE IS THE ARCHITECTURAL MODEL / REPRESENTATION OF THE PROJECT, PROPOSED TO DEVELOPED BY " M/S Direct News Private Limited " 'ALL ITEMS DISPLAYED HEREIN IN THE PLOT MAY NOT NECESSARILY FORM A PART OF THE FINAL BUILDING/ APARTMENT ETC., AS THE CASE MAY BE". THE CONTENTS, PICTURES, IMAGES ETC. PROVIDED IN THE ADVERTISEMENT/ MARKETING/ PROMOTIONAL ACTIVITY ARE PURELY INDICATIVE IN NATURE AND NOT ACTUAL DEPICTION OF THE PLOT/ LANDSCAPES ETC. THE REAL ESTATE (REGULATION AND DEVELOPMENT) ACT, 2016 AND THE RULES MADE THEREUNDER ("RERA") HAS BROUGHT ABOUT SIGNIFICANT CHANGES TO THE REAL ESTATE SECTOR."M/s Direct News Private Limited" IS FULLY COMMITTED TO BE COMPLIANT WITH THE PROVISIONS UNDER RERA" M/S Direct News Private Limited" URGES THE APPLICANT TO INSPECT THE SITE WHERE THE PROJECT IS PROPOSED TO BE CONSTRUCTED. THE APPLICANT SHALL NOT MERELY RELY OR BE INFLUENCED BY ANY ARCHITECT'S PLAN, SALES PLAN, SALES BROCHURES, ADVERTISEMENT, REPRESENTATIONS, WARRANTIES, STATEMENTS OR ESTIMATES OF ANY NATURE WHATSOEVER, WHETHER WRITTEN OR ORAL, MADE BY "M/S Direct News Private Limited" AND SHALL MAKE HIS PERSONAL JUDGMENT PRIOR TO BOOKING A PLOT IN ANY PROJECT OF "M/S Direct News Private Limited", YOU ARE REQUESTED TO CONTACT OUR SALES TEAM TO UNDERSTAND AND BE WELL-VERSED WITH THE CURRENT DETAILS REGARDING ANY PROJECT AND ONLY THEREAFTER YOU ARE REQUESTED TO EVALUATE THE DECISION TO BOOK A PLOT IN ANY PROJECT OF "M/S Direct News Private Limited".

*** Under PMAY subsidy scheme is dependent upon eligibility of each applicant and subject to discretion and bye laws of banks and financial institution only.

GREEN
Circle Homes
AMBALA



M/s Direct News Private Limited | CIN: U70101DL2006PTC279928

(Formerly Known as INX News Private Limited)

Corp. Office: 275-276, Captain Gaur Marg, Srinivaspuri, New Delhi - 110065

Regd. Office: 165, First Floor, Somdu Chamber-II, Bhikaji Cama Place, New Delhi-110066

Email: connect@greencirclehomes.com; Contact Number: +91-7810003388